

TECHNICAL DETAILS: ROCKY MOUNTAIN HARDWARE<sup>®</sup>

ROCKY MOUNTAIN HARDWARE CURVED ESCUTCHEON

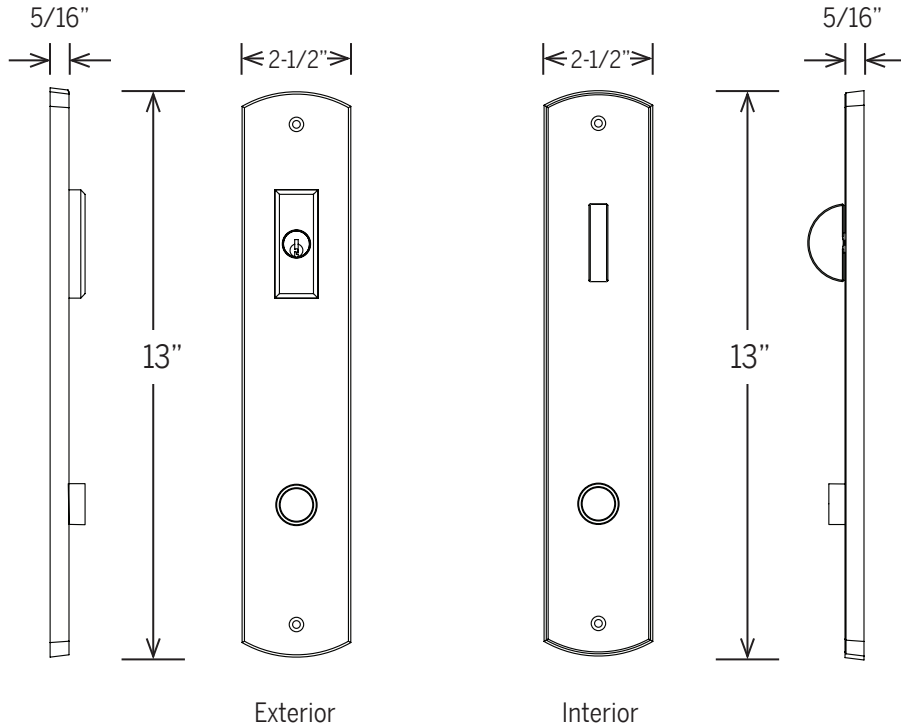

Exterior

Interior

Requires 2-1/8"  $\varnothing$   
Crossbores

**FINISHES**

-  Silicon Bronze Light
-  Silicon Bronze Medium
-  Silicon Bronze Dark
-  Silicon Bronze Rust
-  Silicon Bronze Brushed
-  White Bronze Light
-  White Bronze Medium
-  White Bronze Dark
-  White Bronze Brushed

**CURVED  
HANDLE SET**

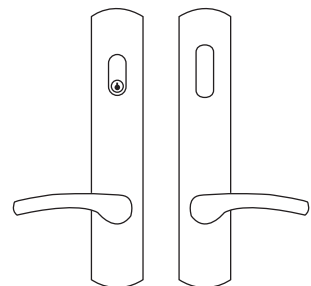

TECHNICAL DETAILS: ROCKY MOUNTAIN HARDWARE<sup>®</sup>

ROCKY MOUNTAIN HARDWARE RECTANGULAR ESCUTCHEON

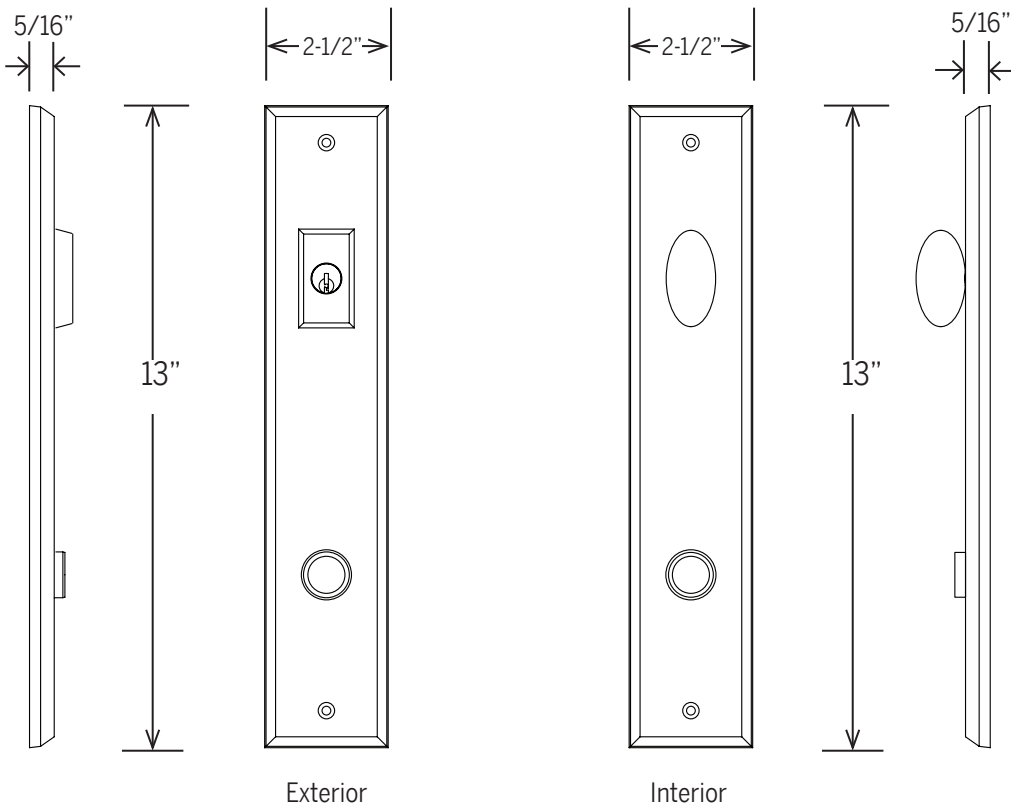

Requires 2-1/8"  $\varnothing$   
Crossbores

- FINISHES**
-  Silicon Bronze Light
  -  Silicon Bronze Medium
  -  Silicon Bronze Dark
  -  Silicon Bronze Rust
  -  Silicon Bronze Brushed
  -  White Bronze Light
  -  White Bronze Medium
  -  White Bronze Dark
  -  White Bronze Brushed

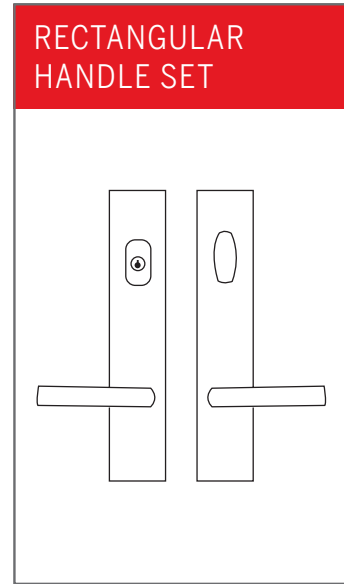

TECHNICAL DETAILS: ROCKY MOUNTAIN HARDWARE<sup>®</sup>

ROCKY MOUNTAIN HARDWARE STEPPED ESCUTCHEON

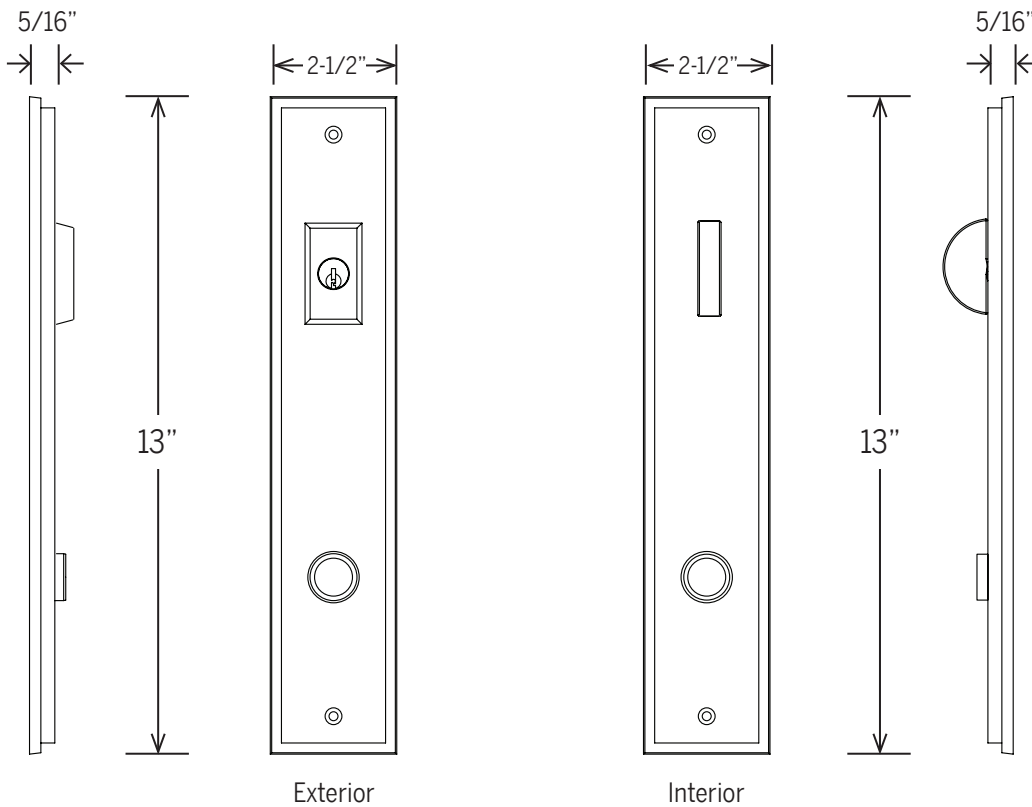

Exterior

Interior

Requires 2-1/8"  $\varnothing$   
Crossbores

FINISHES	
	Silicon Bronze Light
	Silicon Bronze Medium
	Silicon Bronze Dark
	Silicon Bronze Rust
	Silicon Bronze Brushed
	White Bronze Light
	White Bronze Medium
	White Bronze Dark
	White Bronze Brushed

STEPPED HANDLE SET

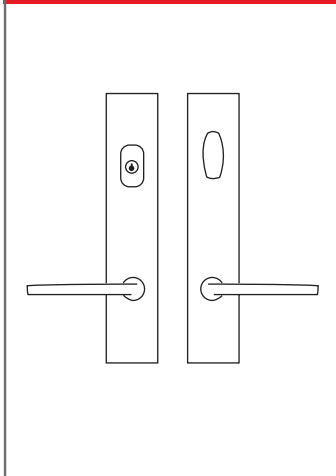

TECHNICAL DETAILS: ROCKY MOUNTAIN HARDWARE<sup>®</sup>

ROCKY MOUNTAIN HARDWARE ARCHED ESCUTCHEON

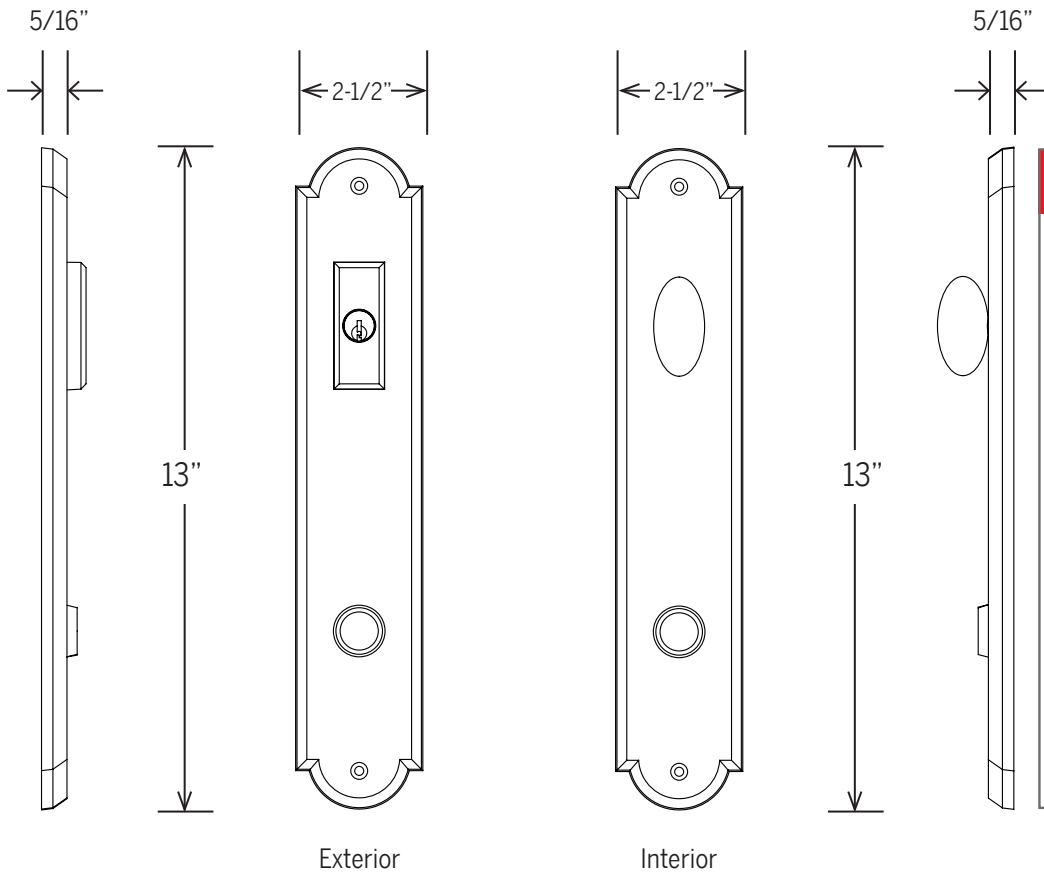

FINISHES	
	Silicon Bronze Light
	Silicon Bronze Medium
	Silicon Bronze Dark
	Silicon Bronze Rust
	Silicon Bronze Brushed
	White Bronze Light
	White Bronze Medium
	White Bronze Dark
	White Bronze Brushed

Requires 2-1/8"  $\varnothing$   
Crossbores

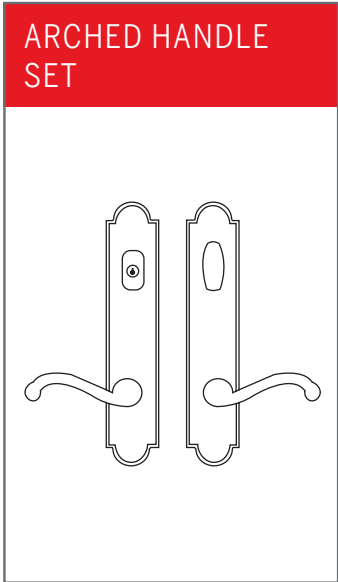

TECHNICAL DETAILS: ROCKY MOUNTAIN HARDWARE<sup>®</sup>

ROCKY MOUNTAIN HARDWARE FLEUR DE LIS ESCUTCHEON

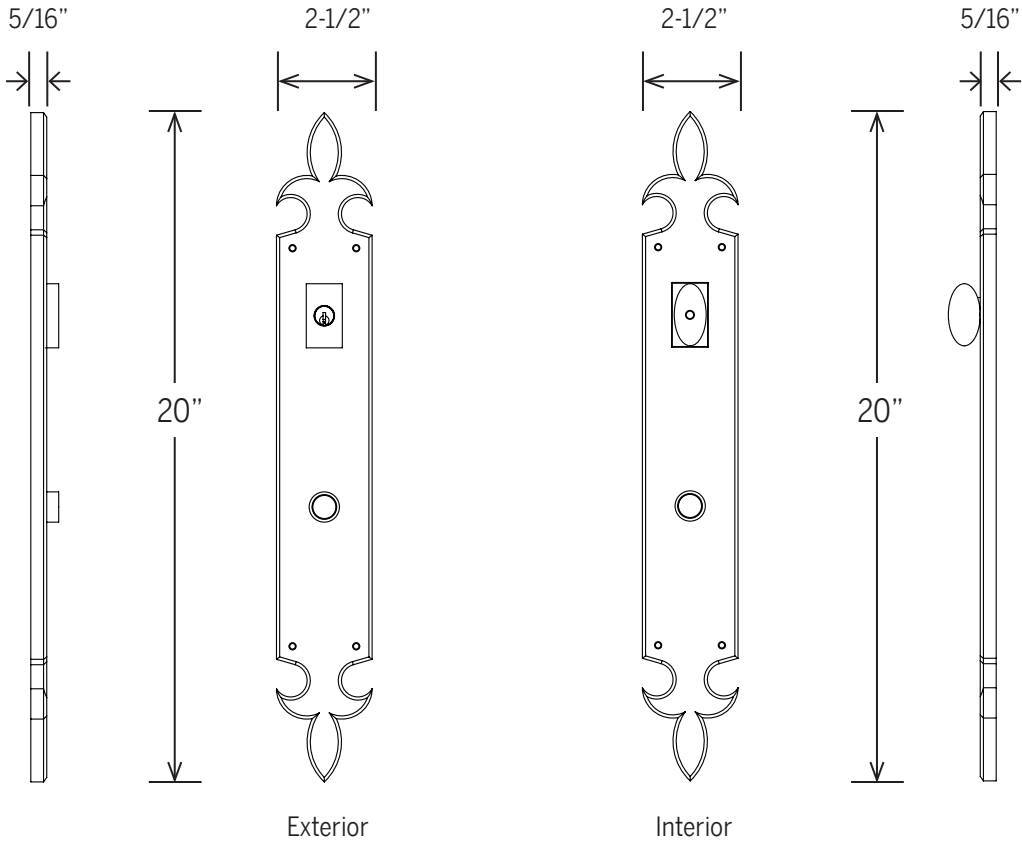

Requires 2-1/8"  $\emptyset$   
Crossbores

FINISHES	
	Silicon Bronze Light
	Silicon Bronze Medium
	Silicon Bronze Dark
	Silicon Bronze Rust
	Silicon Bronze Brushed
	White Bronze Light
	White Bronze Medium
	White Bronze Dark
	White Bronze Brushed

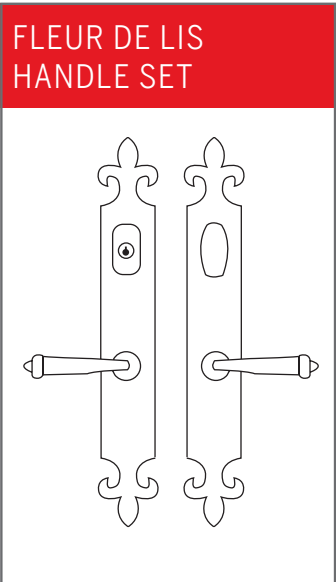

TECHNICAL DETAILS: ROCKY MOUNTAIN HARDWARE<sup>®</sup>

ROCKY MOUNTAIN HARDWARE EXTERIOR ENTRANCE GRIPS (SECTIONAL)

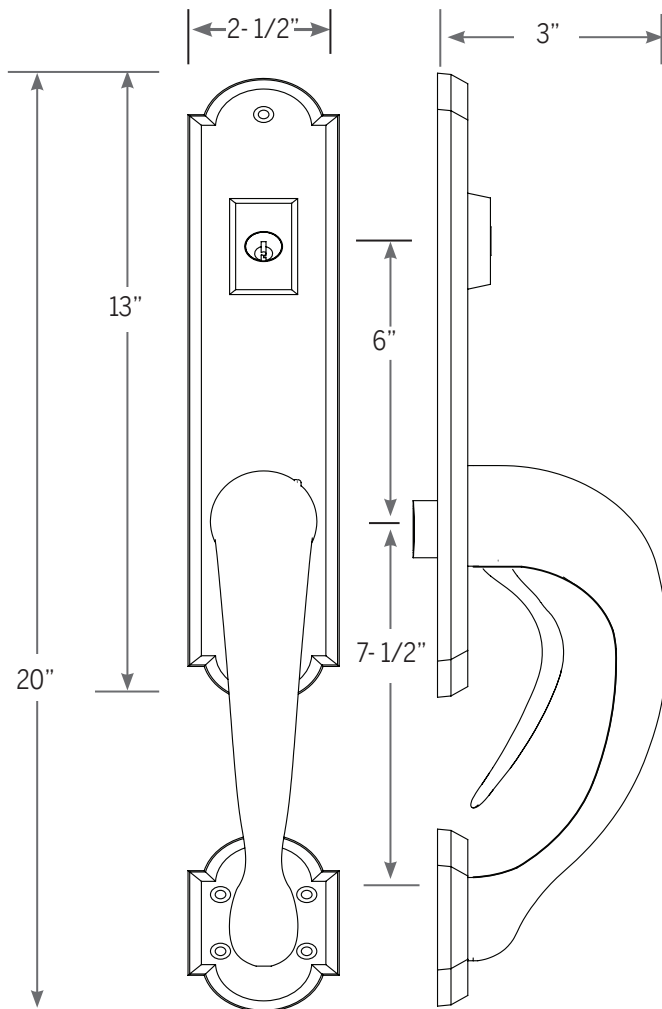

Requires 2-1/8"  $\varnothing$   
Crossbores

**FINISHES**

-  Silicon Bronze Light
-  Silicon Bronze Medium
-  Silicon Bronze Dark
-  Silicon Bronze Rust
-  Silicon Bronze Brushed
-  White Bronze Light
-  White Bronze Medium
-  White Bronze Dark
-  White Bronze Brushed

**ARCHED HANDLE GRIP**

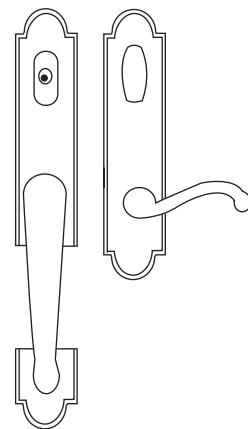

TECHNICAL DETAILS: ROCKY MOUNTAIN HARDWARE<sup>®</sup>

ROCKY MOUNTAIN HARDWARE EXTERIOR ENTRANCE GRIPS (FULL LENGTH)

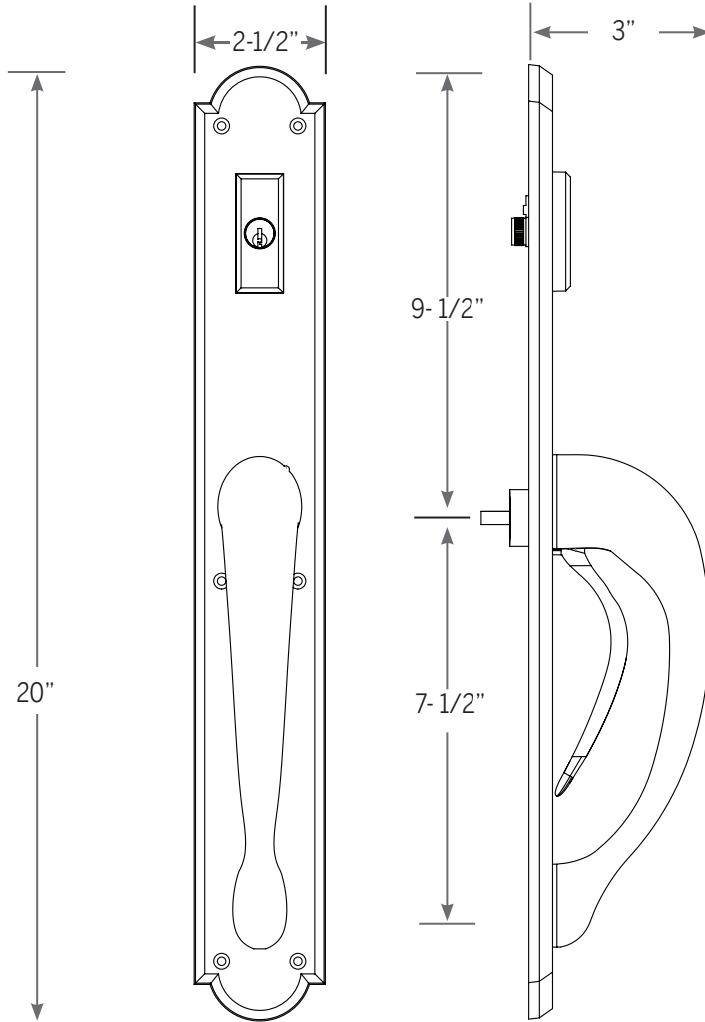

Requires 2-1/8"  $\varnothing$   
Crossbores

**FINISHES**

-  Silicon Bronze Light
-  Silicon Bronze Medium
-  Silicon Bronze Dark
-  Silicon Bronze Rust
-  Silicon Bronze Brushed
-  White Bronze Light
-  White Bronze Medium
-  White Bronze Dark
-  White Bronze Brushed

**ARCHED HANDLE GRIP**

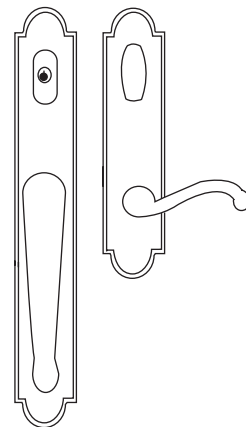

TECHNICAL DETAILS: ROCKY MOUNTAIN HARDWARE<sup>®</sup>

EACH ESCUTCHEON MAY BE COMBINED WITH ANY OF THE FOLLOWING LEVERS AND IS AVAILABLE IN YOUR CHOICE OF NINE PATINA FINISHES.

LEVER OPTIONS



L127  
SCROLL LEVER  
IN SILICON  
BRONZE, DARK



L101  
LONGHORN LEVER  
IN SILICON  
BRONZE, RUST



L110  
CLASSIC LEVER  
IN SILICON BRONZE,  
MEDIUM



L130  
MONARCH LEVER  
IN WHITE BRONZE,  
MEDIUM



L102  
SQUIRREL TAIL  
LEVER IN SILICON  
BRONZE, LIGHT



L111  
TWIG LEVER  
IN SILICON BRONZE,  
RUST



L132  
SQUARE TWIST  
LEVER IN WHITE  
BRONZE, LIGHT



L103 M, L112 L  
CHUB LEVER  
IN WHITE  
BRONZE, MEDIUM



L115 M, L158 L  
ACANTHUS LEVER  
IN SILICON BRONZE,  
MEDIUM



L135  
OLYMPUS LEVER  
IN WHITE BRONZE,  
LIGHT



L104  
HOOK LEVER  
IN SILICON  
BRONZE, RUST



L117  
FRENCH LEVER  
IN SILICON BRONZE,  
DARK



L140  
HARRINGTON LEVER  
IN SILICON  
BRONZE, MEDIUM



L105  
BEAVER TAIL LEVER  
IN SILICON  
BRONZE, RUST



L118  
FRENCH TWIST  
LEVER IN SILICON  
BRONZE, RUST



L150  
BELLA LEVER  
IN SILICON  
BRONZE, DARK



L106  
TALON LEVER IN  
SILICON BRONZE,  
LIGHT



L121 M, L141 L  
ROCK CREEK LEVER  
IN WHITE  
BRONZE, MEDIUM



L160  
WING LEVER  
SILICON BRONZE,  
LIGHT



L107  
SLUGGER LEVER  
IN SILICON BRONZE,  
MEDIUM



L123  
OLD WORLD LEVER  
IN WHITE  
BRONZE, MEDIUM



L163  
EURO LEVER  
IN SILICON  
BRONZE, MEDIUM



L108  
TUBE LEVER  
IN WHITE BRONZE,  
LIGHT



L125  
CLASSIC SCROLL  
LEVER IN WHITE  
BRONZE, MEDIUM



L224  
RIDGE LEVER  
IN SILICON  
BRONZE, MEDIUM



L109 M, L119 L  
LEGACY LEVER  
IN SILICON  
BRONZE, MEDIUM



L126  
TRIPLE TWIST  
LEVER IN WHITE  
BRONZE, LIGHT



L580  
MADDOX LEVER  
IN WHITE  
BRONZE, MEDIUM



L174  
LARIAT LEVER  
IN SILICON  
BRONZE, DARK



L175  
BAMBOO LEVER  
IN SILICON BRONZE,  
MEDIUM



L276  
FALCON LEVER  
IN WHITE  
BRONZE, MEDIUM



L301  
STRAP LEVER  
IN SILICON  
BRONZE, BRUSHED



L304  
REED LEVER  
IN WHITE BRONZE,  
BRUSHED



L307  
JANE LEVER  
IN SILICON BRONZE,  
DARK



L310  
POOL LEVER  
IN WHITE BRONZE,  
LIGHT



L314  
UJ LEVER  
IN SILICON BRONZE,  
DARK



**LEVER SPECIFICATIONS**

L101 Longhorn Lever

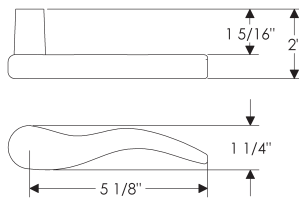

L105 Beaver Tail Lever

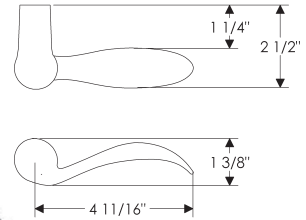

L102 Squirrel Tail Lever

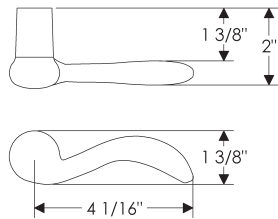

L106 Talon Lever

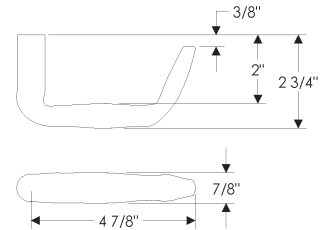

L103 Chub Lever

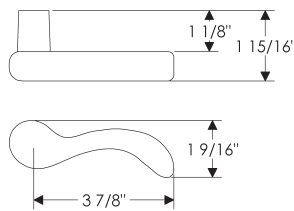

L107 Slugger Lever

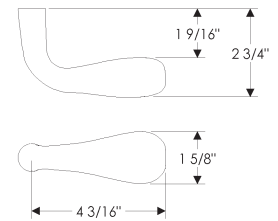
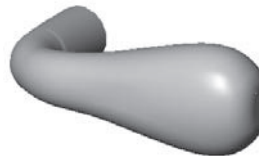

L104 hook lever

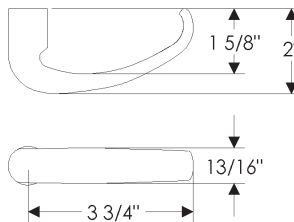

L108 Tube Lever

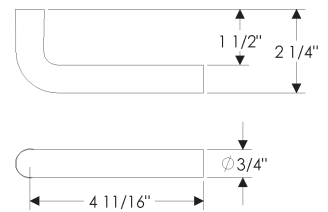
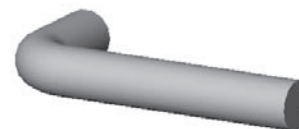

TECHNICAL DETAILS: ROCKY MOUNTAIN HARDWARE<sup>®</sup>

**LEVER SPECIFICATIONS**

L109 Legacy Lever

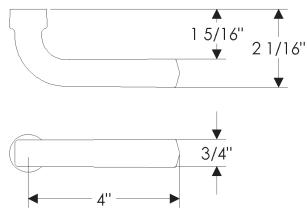
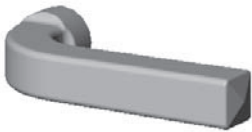

L115 Acanthus Lever

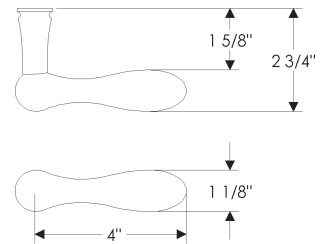

L110 Classic Lever

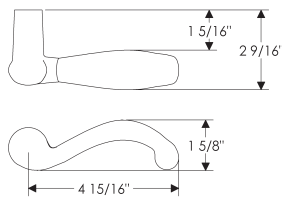

L117 French Lever

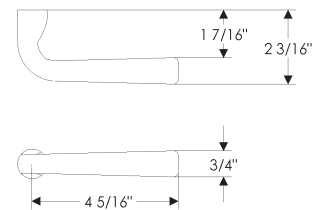
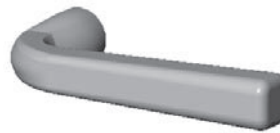

L111 Twig Lever

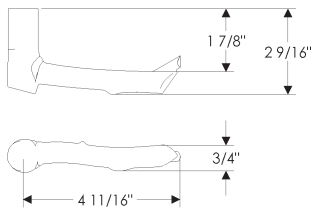

L118 French Twist Lever

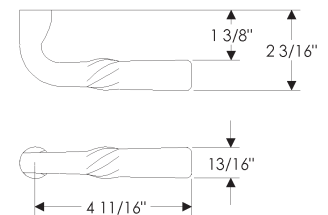
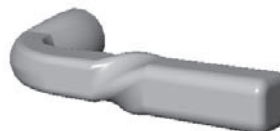

L112 Larger Chub Lever

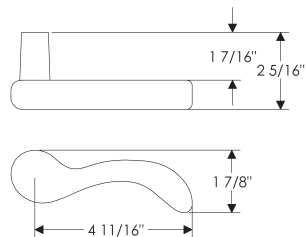

L119 Long Legacy Lever

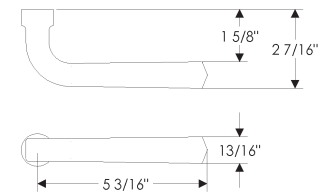
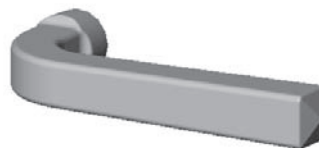

TECHNICAL DETAILS: ROCKY MOUNTAIN HARDWARE<sup>®</sup>

**LEVER SPECIFICATIONS**

L121 Rock Creek Lever

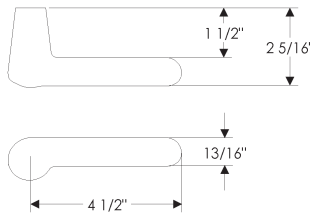
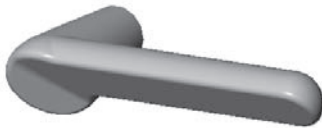

L127 Scroll Lever

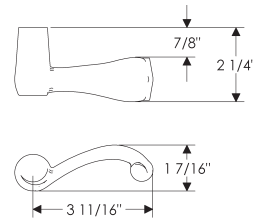

L123 Old World Lever

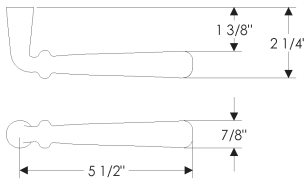
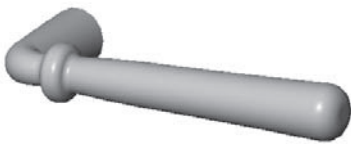

L130 Monarch Lever

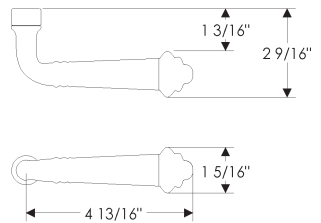
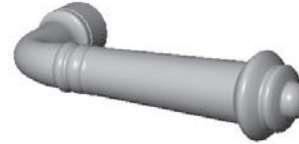

L125 Classic Scroll Lever

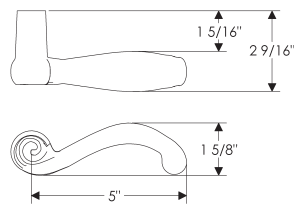

L132 Square Twist Lever

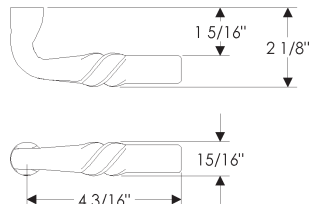
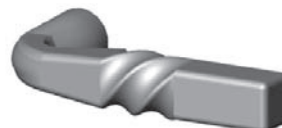

L126 Triple Twist Lever

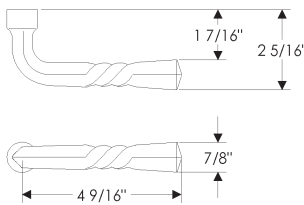
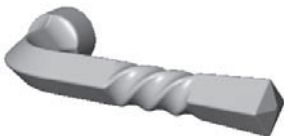

L135 Olypus Lever

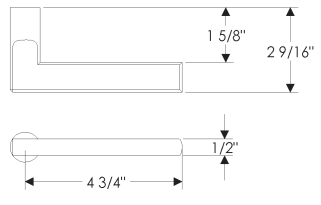
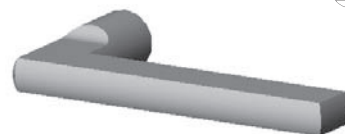

TECHNICAL DETAILS: ROCKY MOUNTAIN HARDWARE<sup>®</sup>

**LEVER SPECIFICATIONS**

L140 Harrington Lever

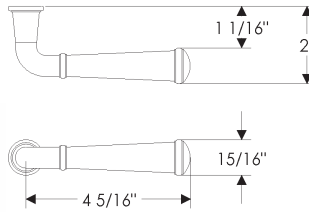

L160 Wing Lever

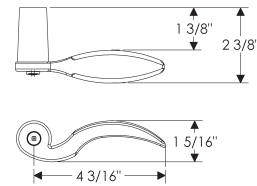

L141 Large Rock Creek Lever

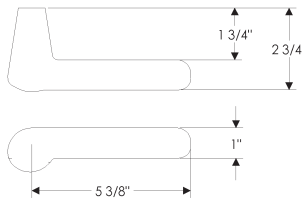
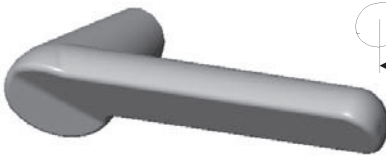

L163 Euro Lever

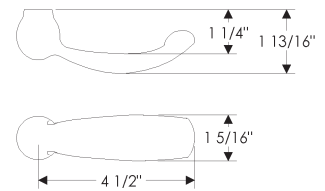
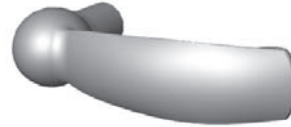

L150 Bella Lever

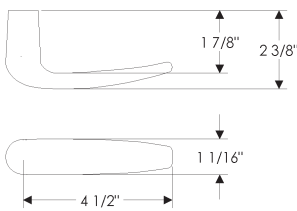

L174 Lariat Lever

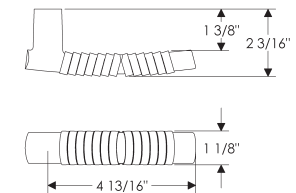
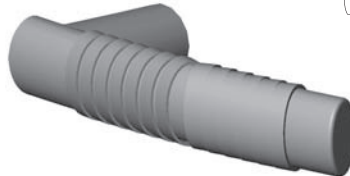

L158 Large Acanthus Lever

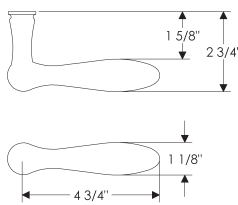
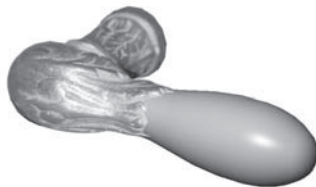

L175 Bamboo Lever

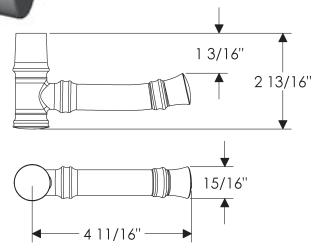
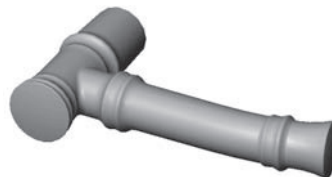

TECHNICAL DETAILS: ROCKY MOUNTAIN HARDWARE<sup>®</sup>

**LEVER SPECIFICATIONS**

L224 Ridge Lever

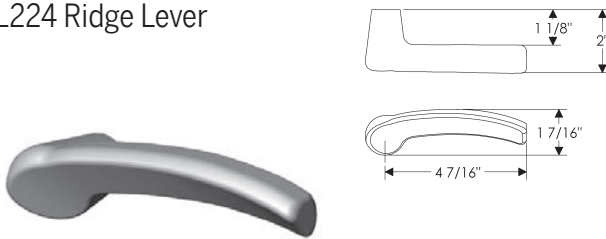

L307 Jane Lever

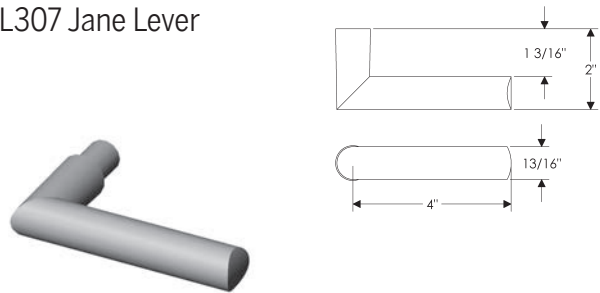

L276 Falcon Lever

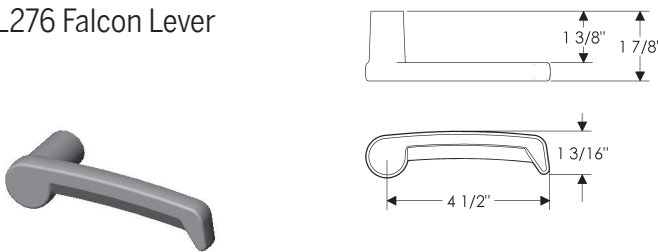

L310 Pool Lever

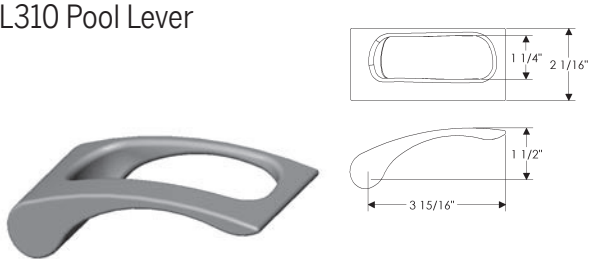

L301 Strap Lever

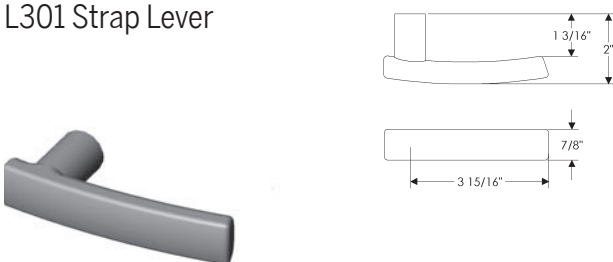

L314 UJ Lever

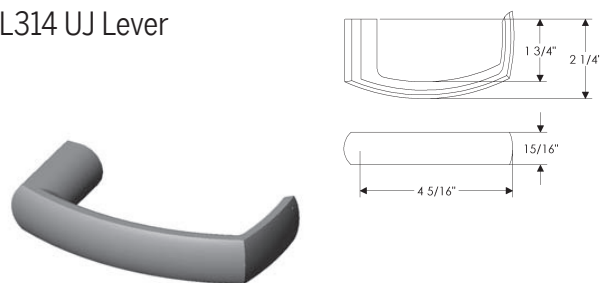

L304 Reed Lever

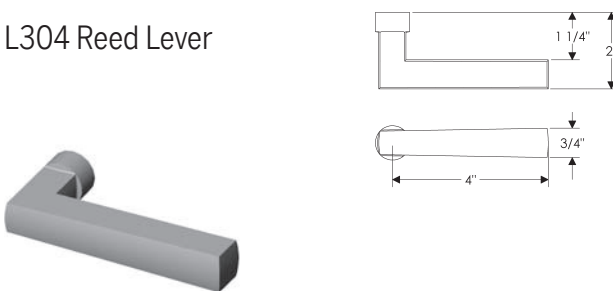

L590 Maddox Lever

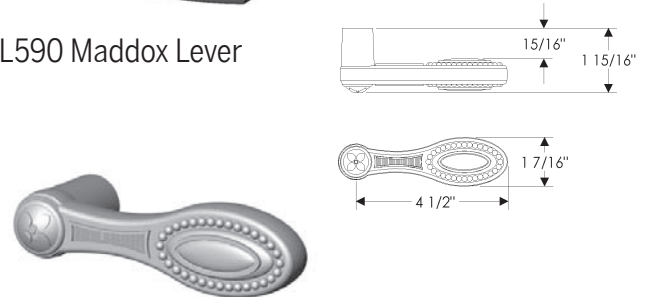

U.S. Patents 5,524,941; 5,524,942; 7,753,418

The information contained in this document is the confidential and proprietary information and trade secrets of Endura Products, Inc. Any disclosure, use or dissemination of such information without the express written permission of Endura Products, Inc. is strictly prohibited. Endura Products, Inc. also owns any and all intellectual property rights embodied in such information, including patent rights, copyrights, and trademark rights, and no license of any intellectual property right is intended, nor should any license be implied, as a result of the receipt of this document.

Rev. 1.13